



CUSTOM REV™ SERIES CARBON FIBER DRIVESHAFT FORM

- 750 HP / 500 lb*ft Max
- 1310 Tube Yokes
- 3.2" Diameter
- Starting at \$1095 MSRP
- PN: JJC-AA0310

STEP 1: Vehicle data:

Year, Make, Model: _____
 Weight: _____ Est. Max MPH: _____

STEP 2: Engine specifications:

Make: _____ Engine Displacement: _____
 Horsepower: _____ Torque: _____ Max RPM: _____

STEP 3: Driveline information:

Transmission Make & Model: _____
 High Gear Ratio: _____ Low Gear Ratio: _____
 Number of Splines on Output Shaft:¹ _____
 Rear Differential Gear Ratio: _____ Rear Tire Size: _____
 Current Driveshaft O.D.: _____ Max O.D. of Driveshaft: _____ Min. Distance to Exhaust: _____

¹ Some transmission yokes have missing splines. If counting the yoke, add the missing spline(s) to get the correct count. If counting the transmission output shaft, it will always have the correct count and no splines will be missing.

STEP 4: Select a U-joint series, slip yoke and rear flange, if applicable.

1. Choose a front and rear U-joint series, using the corresponding figures for dimensions:

Front	Rear	SFI 43.1*	Series	Joint Type	Figure	Cap Dia (D)	Width (E)	Cap Dia (F)	Width (G)
<input type="radio"/>	<input type="radio"/>	<input type="checkbox"/>	1310	Solid	1	1.063"	3.219"	1.063"	3.219"
<input type="radio"/>	<input type="radio"/>	-	1310-1330	Conversion	1	1.063"	3.219"	1.063"	3.622"
<input type="radio"/>	<input type="radio"/>	-	1310-1350	Conversion	1	1.063"	3.219"	1.188"	3.622"
<input type="radio"/>	<input type="radio"/>	-	1310-3R	Conversion	2	1.063"	3.219"	1.125"	2.556"

* To have your driveshaft certified to the SFI 43.1 standard is an additional \$35.

2. Choose a full spline slip yoke option:

- GM 27 - 1.503" O.D., 5.5" Long, Billet
- GM 32 - 1.886" O.D., 5.5" Long, Billet
- Ford 28 - 1.499" O.D., 6.0" Long, Billet
- Ford 31 - 1.684" O.D., 7.0" Long

3. Choose a rear flange yoke option:

- Flange Yoke, 4 Bolt, 2.0" Female Pilot, 3.5" Bolt Hole Circle **+\$100**
- None

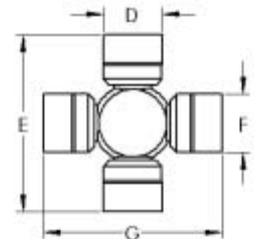

FIGURE 1

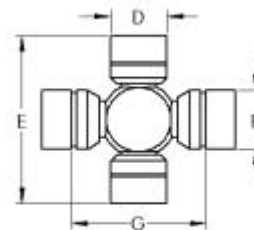

FIGURE 2

STEP 5: Driveshaft measurements taken with vehicle at ride height:

(Measure to within 1/16". Available in lengths up to 65".)

Distance from center of front U-joint to center of rear U-joint (A)²: _____

Distance from end of transmission tail housing to center of rear U-joint (B): _____

Distance from end of output shaft to end of transmission tail housing (C): _____

Distance from end of slip yoke to center of front U-joint (D): _____

Distance from center of front U-joint to end of flange yoke (E): _____

² Take this u-joint center-to-center measurement with the slip yoke in its operating position. The slip yoke operating position is typically determined by pulling the slip yoke out of the transmission 1" after it is fully bottomed out.

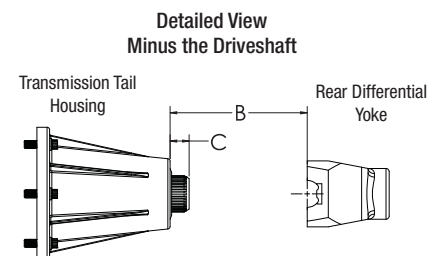
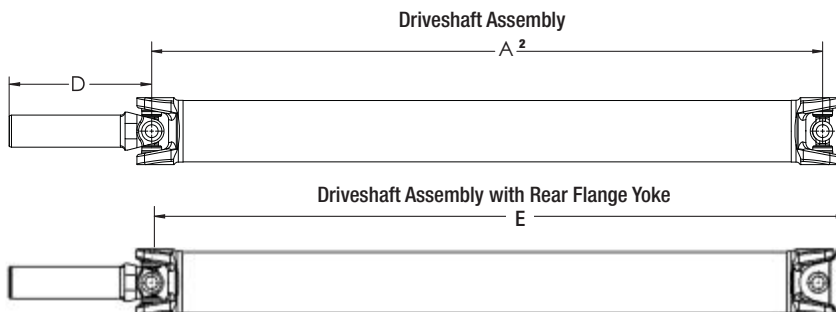

ORDER FORM



LEGAL DISCLAIMER NOTICE

This composite driveshaft product and related components are sold as-is without any warranty whatsoever, expressed or implied, including but not limited to any implied warranties of merchantability or fitness for a particular purpose. QA1 assumes no responsibility or liability for the selection, installation or any use of the products. The end user acknowledges that the product will be used for vehicles with not more than 2000 HP with max torque of 1500 lb*ft for driveshafts using 1350 Series U-joints and not more than 750 HP with max torque of 500 lb*ft for driveshafts using all other U-joints and assumes any and all risks related to such activities. The end user and any person who installs this product and related components are solely responsible for determination of the suitability of the product and components selected. The end user installs and uses the products and components at their own risk and agrees to fully indemnify QA1 against any claims, damages or losses resulting from the selection, installation or use of the products or related components.

Only experienced and qualified persons should install the products and components. Failure to properly install the product or related components may result in vehicle damage, personal injury or death.

QA1 IS NOT RESPONSIBLE FOR IMPROPER OR INCORRECT INFORMATION PROVIDED BY CUSTOMER.

ALL SALES FINAL.

Warning: Be sure to inspect all components regularly, especially following a crash. Do not use any components which may have been damaged.

Warning: If composite driveshaft is dropped or damaged, it should be taken out of service and replaced.

QUESTIONS?

For any questions, please contact Motor State (info below) or QA1 at 800.721.7761 or 952.985.5675 to speak to a support specialist. QA1 office hours are Monday - Friday, 8 am - 5 pm CST.

Motor State Distributing
8300 Lane Drive, Watervliet MI 49098
web: www.motorstate.com | phone: 1-800-772-2678 | fax: 1-800-772-2618



Custom Order Release

Please be advised that in placing this order for custom manufactured merchandise you are accepting full responsibility for the correctness and accuracy of all pertinent ordering information. Further, be advised that by filling out and signing this form you are affirming the correctness and accuracy of the information contained herein and authorizing Motor State Distributing to order this custom merchandise. Once this form has been signed, the purchaser assumes full responsibility for paying for the custom merchandise and no refund will be issued unless it can be shown that any errors or defects were the fault of the manufacturer and not caused by erroneous information.

As a rule, custom orders cannot be cancelled once the order is placed with the manufacturer. All custom orders are subject to freight and handling charges from the manufacturer.

No returns will be accepted on custom-built items.

Sales Contact At Motor State _____

Customer Number _____

Company Name _____

Address _____

City _____ State _____ Zip _____

Phone _____

Fax _____

Email _____

Print Your Name _____ Date _____

Authorized Signature _____

If you are submitting this form electronically, your digital signature must be added last. Once signed, this form becomes non-editable. Please double check all items first.

Motor State Distributing

8300 Lane Drive, Watervliet MI 49098

web: www.motorstate.com | phone: 1-800-772-2678 | fax: 1-800-772-2618