

STRANGE AXLE AND HOUSING ORDERING SHEET (847) 663.1701

**AXLES** To place an order for axles please provide us with the information listed below. If an existing axle is unavailable for dimension (C)- complete the information for "Rear End/Housings" (below) and we will calculate the proper axle length. If you need assistance with any dimensions please call us. We will be happy to assist you in any way we can to ensure that you receive a proper fitting axle.

- Application (Drag, Street, Oval...) \_\_\_\_\_
- Type (Posi, Spool...) & Brand of Carrier \_\_\_\_\_
- Number of Axle Splines \_\_\_\_\_
- Bolt Circle(s) (B.C.) \_\_\_\_\_  
(or **(X)** - 4-lug patterns also available)
- Screw-In Studs \_\_\_\_\_  
(specify 1/2-20 or 5/8-18)
- Housing End Type \_\_\_\_\_  
(see chart below)
- Type of Brakes \_\_\_\_\_  
(be as specific as possible)
- Strange Axle Flange O.D. is **6.245"** Unless Otherwise Specified **(D)** \_\_\_\_\_

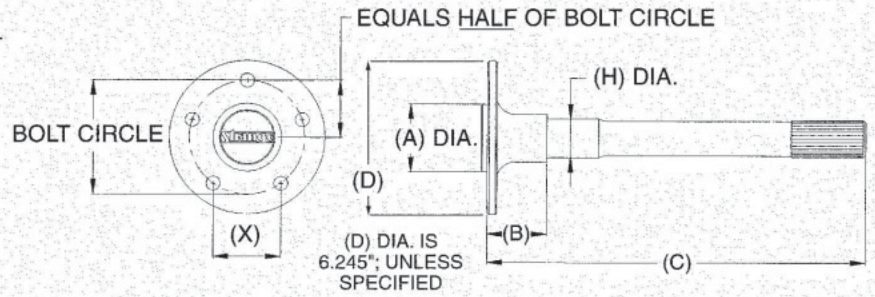

Driver Side (C) _____	Pass. Side (C) _____	"X" Bolt Circle
(A) _____	(B) _____	2.645" 4.50"
(H) _____	(F) (See housing Drawing below) _____	2.792" 4.750"
		2.939" 5.00"
		3.233" 5.50"

NOTES: (1) (B) dimension should be measured with the axle bearing removed. If you can not remove the axle bearing- Ensure that you supply a proper (F) dim.  
(2) (H) Dimension is not necessary if receiving bearings from Strange.

**REAR END/HOUSINGS** Due to the wide variety of wheel widths, wheel offsets, tire sizes, and chassis designs, there is not a standard narrowed housing width for any car. To properly measure your car for a narrowed housing, position the wheels and tires in the wheel wells and measure between the wheel mounting surfaces.

To ensure proper driveshaft alignment, the pinion offset should be the same as the engine and driveshaft offset. Measure the distance between the transmission output shaft and the centerline of the body to determine this dimension (or see housing chart below).

To order a custom housing OR if you want us to calculate axle lengths- please provide the following information:

- Passenger Side Housing End to C.P. (L) \_\_\_\_\_
- Driver Side Housing End to C.P. (O) \_\_\_\_\_
- Housing End to Housing End (L) + (O) \_\_\_\_\_
- Passenger Side Axle Flange to C.P. (M) \_\_\_\_\_
- Driver Side Axle Flange to C.P. (J) \_\_\_\_\_
- Axle Flange to Axle Flange (Wheel to Wheel) equals (M) + (J) \_\_\_\_\_

NOTES: (1) Axle flange to Axle Flange is measured from the OUTSIDE (Wheel Side) of the axle's flange to OUTSIDE (Wheel Side) of the opposite axle's flange. (2) If you have listed only housing end to housing end or axle flange to axle flange- you must specify pinion offset.

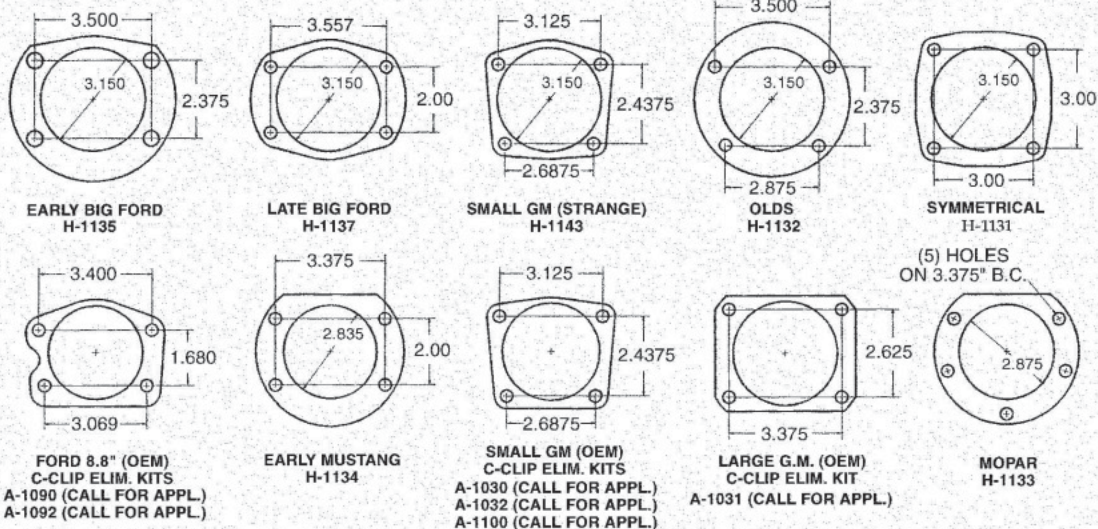
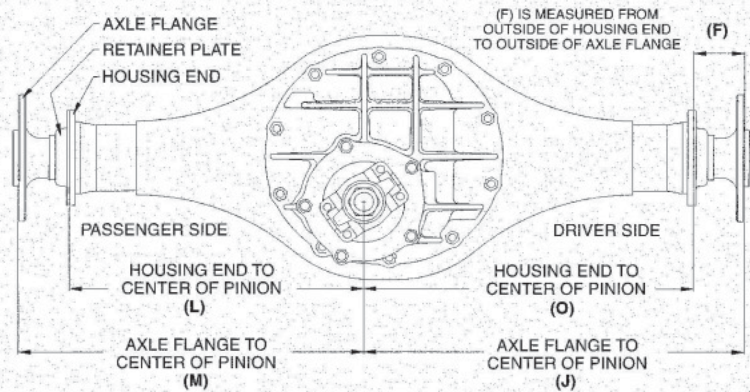

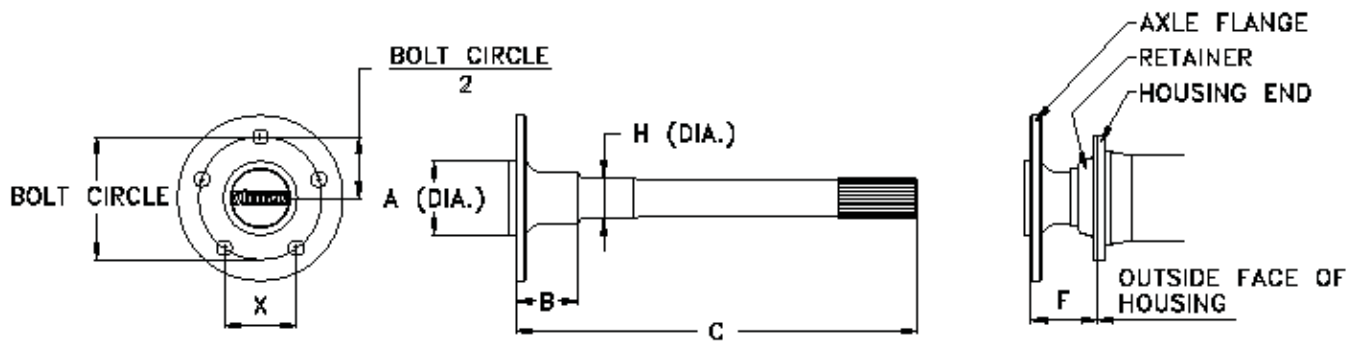

**A- Brake register:** Centers the factory brake drum or rotor. May also center some aftermarket rotors. Most Drag Racing brake rotors center on the wheel studs.

**B- Bearing shoulder:** The bearing stop machined on the axle. The “B” dimension is not the same as axle offset (“F”) since most axle bearings do not sit flush with the housing end. Also, the style of axle bearing, ball or tapered, will result in a different “F” even if the “B” is the same.

**F- Axle offset:** The distance from the outside face of the axle flange, to the outside face of the housing end.

**H- Bearing area diameter:** Diameter of the axle for the bearing press fit.

**Bolt circle:** The circle the stud holes are drilled on. This can not be measured from the center of stud to the center of an opposing stud. In an odd number of bolt holes (i.e. 5 lug), no stud is 180 degrees from another. You could measure from the center of the axle to the center of a stud and multiply by 2. For 5 lug patterns, you can measure the “X” and use our chart.

**Axle flange:** Strange axle flanges measure 6.245” unless specified otherwise. With some brakes, a smaller axle flange diameter is required. Some may also need an access hole to tighten brake components.

### Common Dimensions

**Chrysler/Dodge/Mopar-** A= 2.300” or 2.820” / B= 2.200”, 2.3125”, or 2.5625” / \*F= 2.1375”, 2.250”, or 2.500”  
H= 1.5635” / B.C.= 5 on 4”, or 5 on 4 ½” \*Note: “F” must be measured with all brake components installed.

**Ford-** A= 2.430”, 2.530”, 2.750”, 2.780”, 2.875”, or 3.060”  
B= 1.875”, 2.0625”, 2.250”, 2.375”, 2.4375”, or none with c-clip style axle  
F= 2.145”, 2.332”, or 2.500”  
H= 1.379”, 1.400”, 1.532”, 1.5635”, or 1.6265” / B.C.= 4 on 4 ¼”, 5 on 4 ½”, 5 on 5”, or 5 on 5 ½”.

**G.M.-** A= 2.780”, 2.812”, or 3.060” / B= 2.5625” or none with c-clip style axles / F= 2.832  
H= 1.379”, 1.400”, or 1.532” / B.C.= 5 on 4 ¾” or 5 on 5”

**Note:** “B” measurements should be taken with the axle bearings removed. Many seals cover up the true “B”.

**X:** 2.645” = 4 ½” BC / 2.792” = 4 ¾” BC / 2.939” = 5” BC / 3.233” = 5 ½” BC



## Custom Order Release

Please be advised that in placing this order for custom manufactured merchandise you are accepting full responsibility for the correctness and accuracy of all pertinent ordering information. Further, be advised that by filling out and signing this form you are affirming the correctness and accuracy of the information contained herein and authorizing Motor State Distributing to order this custom merchandise. Once this form has been signed, the purchaser assumes full responsibility for paying for the custom merchandise and no refund will be issued unless it can be shown that any errors or defects were the fault of the manufacturer and not caused by erroneous information.

As a rule, custom orders cannot be cancelled once the order is placed with the manufacturer. All custom orders are subject to freight and handling charges from the manufacturer.

**No returns will be accepted on custom-built items.**

Sales Contact At Motor State \_\_\_\_\_

Customer Number \_\_\_\_\_

Company Name \_\_\_\_\_

Address \_\_\_\_\_

City \_\_\_\_\_ State \_\_\_\_\_ Zip \_\_\_\_\_

Phone \_\_\_\_\_

Fax \_\_\_\_\_

Email \_\_\_\_\_

Print Your Name \_\_\_\_\_ Date \_\_\_\_\_

Authorized Signature \_\_\_\_\_

**If you are submitting this form electronically, your digital signature must be added last. Once signed, this form becomes non-editable. Please double check all items first.**

Motor State Distributing  
8300 Lane Drive, Watervliet MI 49098

web: [www.motorstate.com](http://www.motorstate.com) | phone: 1-800-772-2678 | fax: 1-800-772-2618